



General Information

Specifications	9500lb (4309kg) - Edge Series Bare Winch
	12 Volt
Gear Ratio	212:1
Gear Tran	3 Stage Planetary
Clutch	Sliding Ring Gear
Motor Type	Series Wound
Motor	4.8 Hp, 3.6 Kw
Control	Hand Control, 5m lead
Braking	Automatic load holding in drum
Drum Size	67mm x 228mm (2.64" x 9")
Cable - Galvanised Aircraft	N/A
Clevis Hook	N/A
Overall Dimensions (L x W x H)	570mm x 168mm x 175mm (22.45" x 6.62" x 6.89")
Net Weight	22kg
Mounting Bolt Pattern	254mm x 114.3mm (10" x 4.5")
Battery Power Cables	2 x 1900mm x 25mm ² , Tinned Copper with Colour Coding Sheath Protection
Motor Power Cables	3 x 450mm x 25mm ² , Tinned Copper with Colour Coding Sheath Protection
Recommended Battery	minimum 650CCA
Finish	power coating

Performance of 1st Layer

Line Pull	Line Speed	Motor Amp Draw	Current
0 lbs 0 kgs	19 Fpm 5.8 Mpm	110	12 Volt
4000 lbs 1816 kgs	12.5 Fpm 3.8 Mpm	210	12 Volt
6000 lbs 2724 kgs	10.5 Fpm 3.2 Mpm	260	12 Volt
8000 lbs 3632 kgs	8.6 Fpm 2.6 Mpm	300	12 Volt
9500 lbs 4309 kgs	7.9 Fpm 2.4 Mpm	350	12 Volt

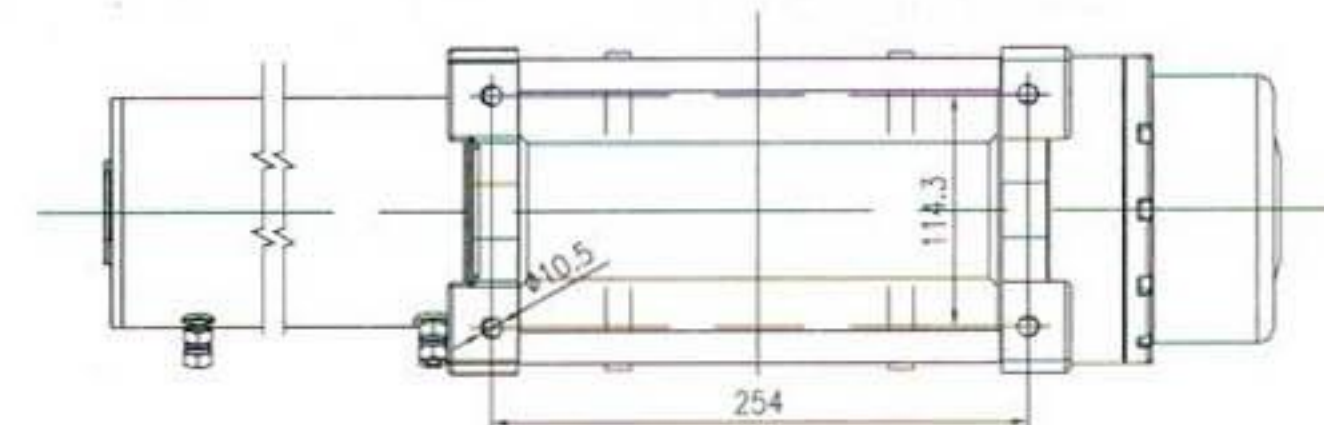
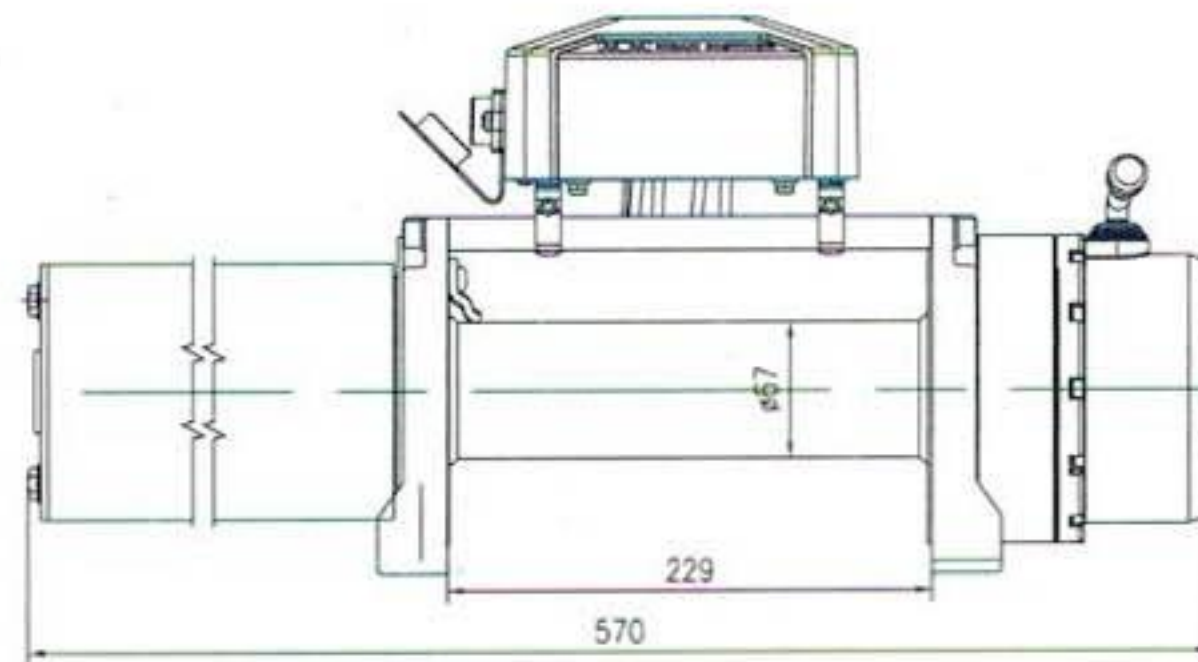
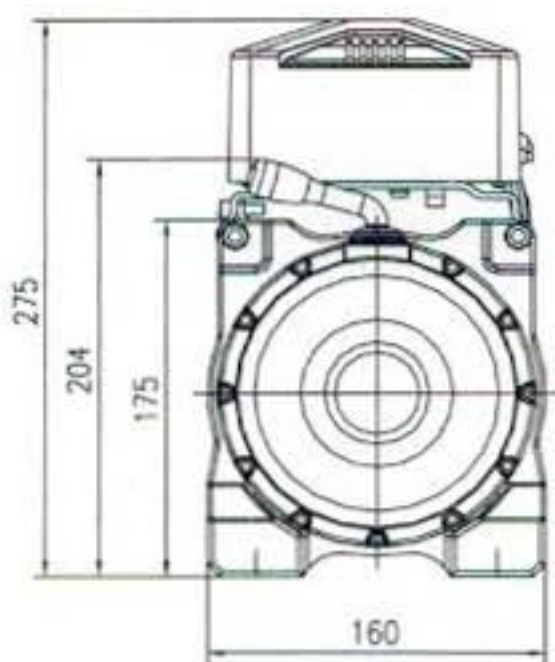



General Information

Specifications	9500lb (4309kg) - Edge Series With Synthetic Rope
	12 Volt
Gear Ratio	212:1
Gear Tran	3 Stage Planetary
Clutch	Sliding Ring Gear
Motor Type	Series Wound
Motor	4.8 Hp, 3.6 Kw
Control	Hand Control, 5m lead
Braking	Automatic load holding in drum
Drum Size	67mm x 228mm (2.64" x 9")
Cable Genuine Dyneema® SK75	9.53mm x 30.5 Metres (3/8" x 100')
Clevis Hook	10-8
Overall Dimensions (L x W x H)	570mm x 168mm x 175mm (22.45" x 6.62" x 6.89")
Net Weight	31kg
Mounting Bolt Pattern	254mm x 114.3mm (10" x 4.5")
Battery Power Cables	2 x 1900mm x 25mm ² , Tinned Copper with Colour Coding Sheath Protection
Motor Power Cables	3 x 450mm x 25mm ² , Tinned Copper with Colour Coding Sheath Protection
Recommended Battery	minimum 650CCA
Finish	power coating

Performance of 1st Layer

Line Pull	Line Speed	Motor Amp Draw	Current
0 lbs 0 kgs	19 Fpm 5.8 Mpm	110	12 Volt
4000 lbs 1816 kgs	12.5 Fpm 3.8 Mpm	210	12 Volt
6000 lbs 2724 kgs	10.5 Fpm 3.2 Mpm	260	12 Volt
8000 lbs 3632 kgs	8.6 Fpm 2.6 Mpm	300	12 Volt
9500 lbs 4309 kgs	7.9 Fpm 2.4 Mpm	350	12 Volt

Line Pull & Cable Capacity by Layer

Cable Layer	Rated Line Pull	Cable Capacity
1	9500 lbs 4309 kgs	15 Feet 5 Metres
2	7500 lbs 3402 kgs	38 Feet 11.5 Metres
3	6200 lbs 2812 kgs	64 Feet 19.5 Metres
4	5300 lbs 2404 kgs	95 Feet 29 Metres
5	4630 lbs 2100 kgs	100Feet 30.5 Metres

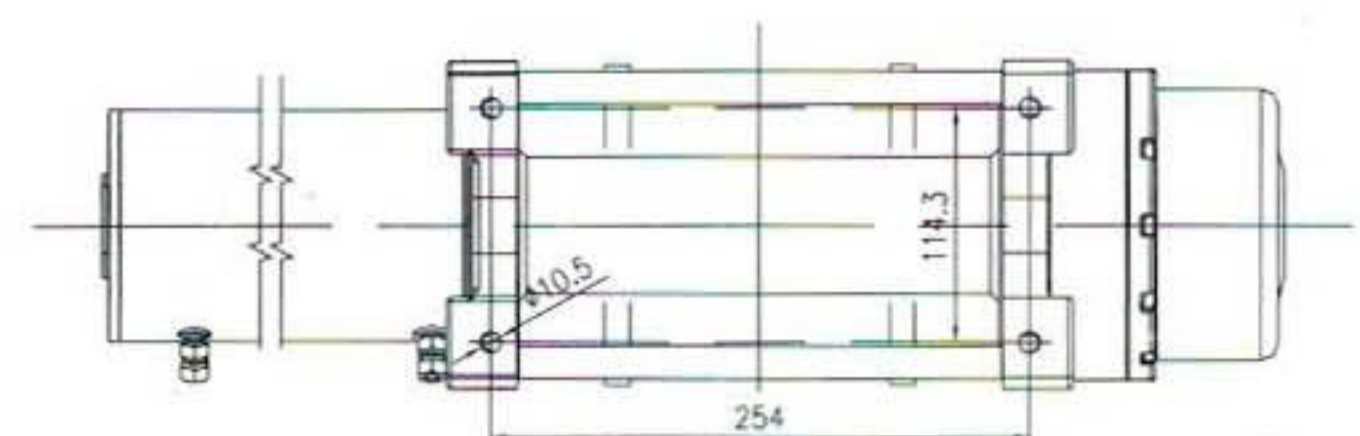
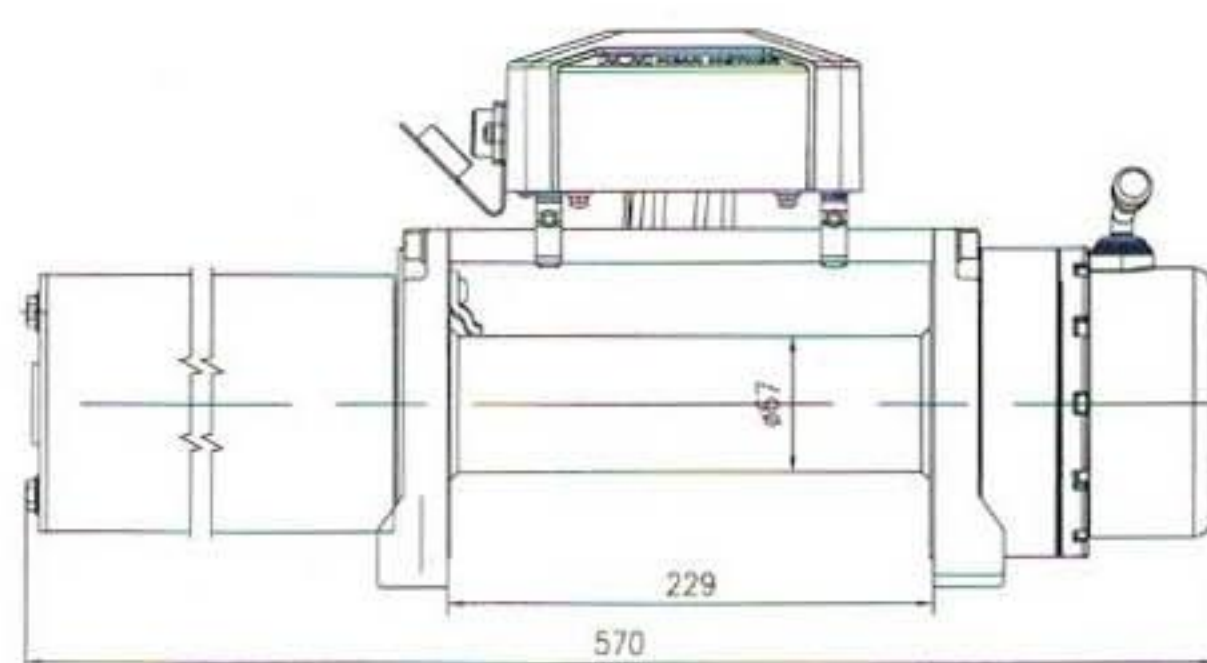
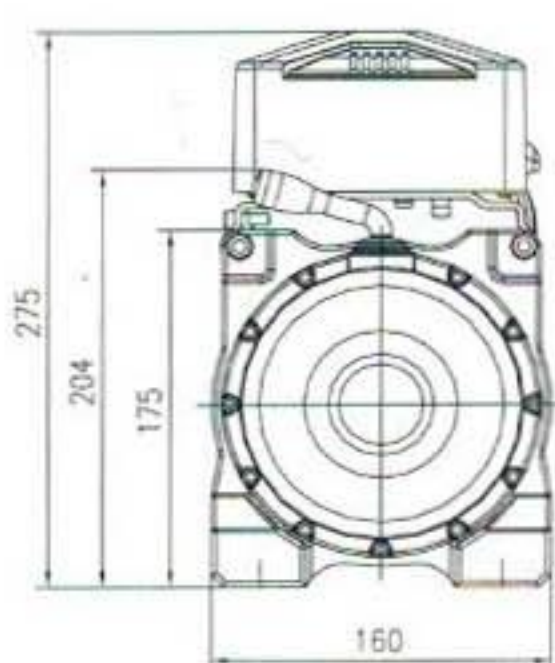



General Information

Specifications	9500lb (4309kg) - Edge Series
	12 Volt
Gear Ratio	212:1
Gear Tran	3 Stage Planetary
Clutch	Sliding Ring Gear
Motor Type	Series Wound
Motor	4.8 Hp, 3.6 Kw
Control	Hand Control, 5m lead
Braking	Automatic load holding in drum
Drum Size	67mm x 228mm (2.64" x 9")
Cable - Galvanised Aircraft	9.53mm x 30.5 Metres (3/8" x 100')
Clevis Hook	3/8"
Overall Dimensions (L x W x H)	570mm x 168mm x 175mm (22.45" x 6.62" x 6.89")
Net Weight	43kg
Mounting Bolt Pattern	254mm x 114.3mm (10" x 4.5")
Battery Power Cables	2 x 1900mm x 25mm ² , Tinned Copper with Colour Coding Sheath Protection
Motor Power Cables	3 x 450mm x 25mm ² , Tinned Copper with Colour Coding Sheath Protection
Recommended Battery	minimum 650CCA
Finish	power coating

Performance of 1st Layer

Line Pull	Line Speed	Motor Amp Draw	Current
0 lbs 0 kgs	19 Fpm 5.8 Mpm	110	12 Volt
4000 lbs 1816 kgs	12.5 Fpm 3.8 Mpm	210	12 Volt
6000 lbs 2724 kgs	10.5 Fpm 3.2 Mpm	260	12 Volt
8000 lbs 3632 kgs	8.6 Fpm 2.6 Mpm	300	12 Volt
9500 lbs 4309 kgs	7.9 Fpm 2.4 Mpm	350	12 Volt

Line Pull & Cable Capacity by Layer

Cable Layer	Rated Line Pull	Cable Capacity
1	9500 lbs 4309 kgs	15 Feet 5 Metres
2	7500 lbs 3402 kgs	38 Feet 11.5 Metres
3	6200 lbs 2812 kgs	64 Feet 19.5 Metres
4	5300 lbs 2404 kgs	95 Feet 29 Metres
5	4630 lbs 2100 kgs	100 Feet 30.5 Metres

