



RHINO-RACK

CXBS1

CONTROLLED

Item	Component	Qty	Part No.
1	M8 x 30mm Hex	2	B026
2	M6 x 20mm Hex	2	B082
3	Rails Spacer No.1	2	M080
4	M6 Nyloc Nuts	2	N013
5	M6 x 12.5mm Flat Washer	2	W003

Note:
CXBS1 is intended for use with CXB leg kits. For detailed installation instructions, refer to CXB instructions (RR61).

*Included in CXB leg kit hardware.

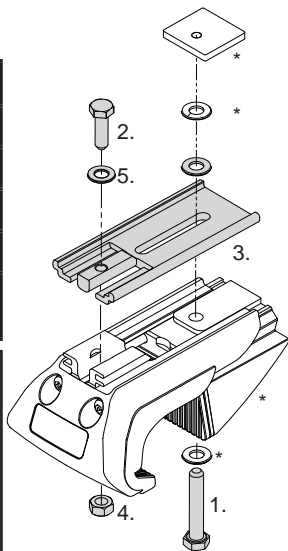

Issue: 01

Document No: R1358

Prepared: Kayle Everett



RHINO-RACK

CXBS1

CONTROLLED

Item	Component	Qty	Part No.
1	M8 x 30mm Hex	2	B026
2	M6 x 20mm Hex	2	B082
3	Rails Spacer No.1	2	M080
4	M6 Nyloc Nuts	2	N013
5	M6 x 12.5mm Flat Washer	2	W003

Note:
CXBS1 is intended for use with CXB leg kits. For detailed installation instructions, refer to CXB instructions (RR61).

*Included in CXB leg kit hardware.

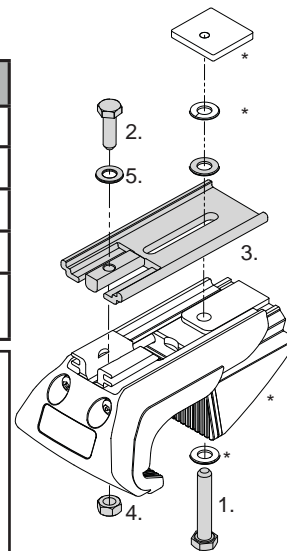

Issue: 01

Document No: R1358

Prepared: Kayle Everett



RHINO-RACK

CXBS1

CONTROLLED

Item	Component	Qty	Part No.
1	M8 x 30mm Hex	2	B026
2	M6 x 20mm Hex	2	B082
3	Rails Spacer No.1	2	M080
4	M6 Nyloc Nuts	2	N013
5	M6 x 12.5mm Flat Washer	2	W003

Note:
CXBS1 is intended for use with CXB leg kits. For detailed installation instructions, refer to CXB instructions (RR61).

*Included in CXB leg kit hardware.

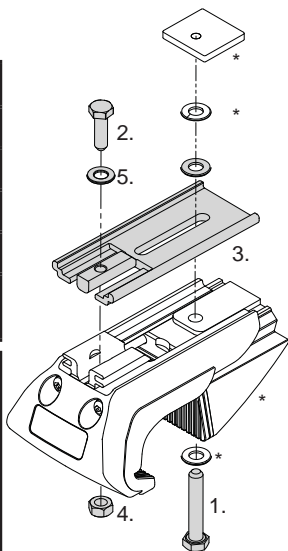

Issue: 01

Document No: R1358

Prepared: Kayle Everett



RHINO-RACK

CXBS1

CONTROLLED

Item	Component	Qty	Part No.
1	M8 x 30mm Hex	2	B026
2	M6 x 20mm Hex	2	B082
3	Rails Spacer No.1	2	M080
4	M6 Nyloc Nuts	2	N013
5	M6 x 12.5mm Flat Washer	2	W003

Note:
CXBS1 is intended for use with CXB leg kits. For detailed installation instructions, refer to CXB instructions (RR61).

*Included in CXB leg kit hardware.

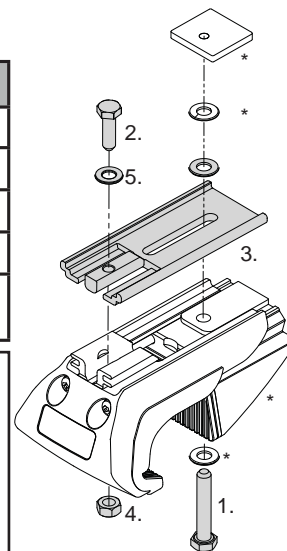

Issue: 01

Document No: R1358

Prepared: Kayle Everett



RHINO-RACK

CXBS1

CONTROLLED

Item	Component	Qty	Part No.
1	M8 x 30mm Hex	2	B026
2	M6 x 20mm Hex	2	B082
3	Rails Spacer No.1	2	M080
4	M6 Nyloc Nuts	2	N013
5	M6 x 12.5mm Flat Washer	2	W003

Note:
CXBS1 is intended for use with CXB leg kits. For detailed installation instructions, refer to CXB instructions (RR61).

*Included in CXB leg kit hardware.

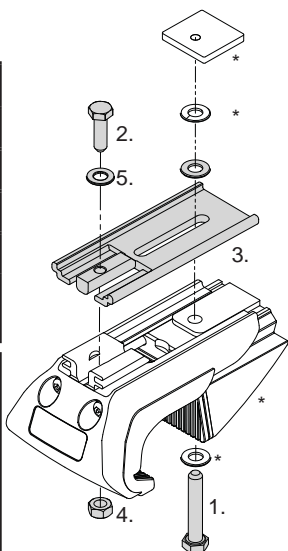

Issue: 01

Document No: R1358

Prepared: Kayle Everett



RHINO-RACK

CXBS1

CONTROLLED

Item	Component	Qty	Part No.
1	M8 x 30mm Hex	2	B026
2	M6 x 20mm Hex	2	B082
3	Rails Spacer No.1	2	M080
4	M6 Nyloc Nuts	2	N013
5	M6 x 12.5mm Flat Washer	2	W003

Note:
CXBS1 is intended for use with CXB leg kits. For detailed installation instructions, refer to CXB instructions (RR61).

*Included in CXB leg kit hardware.

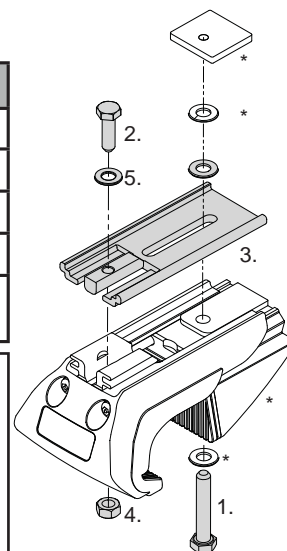

Issue: 01

Document No: R1358

Prepared: Kayle Everett